

BI-PARTING SLIDING (SINGLE GLAZED)

240v Switched, fused, illuminated spur within 1m of operator

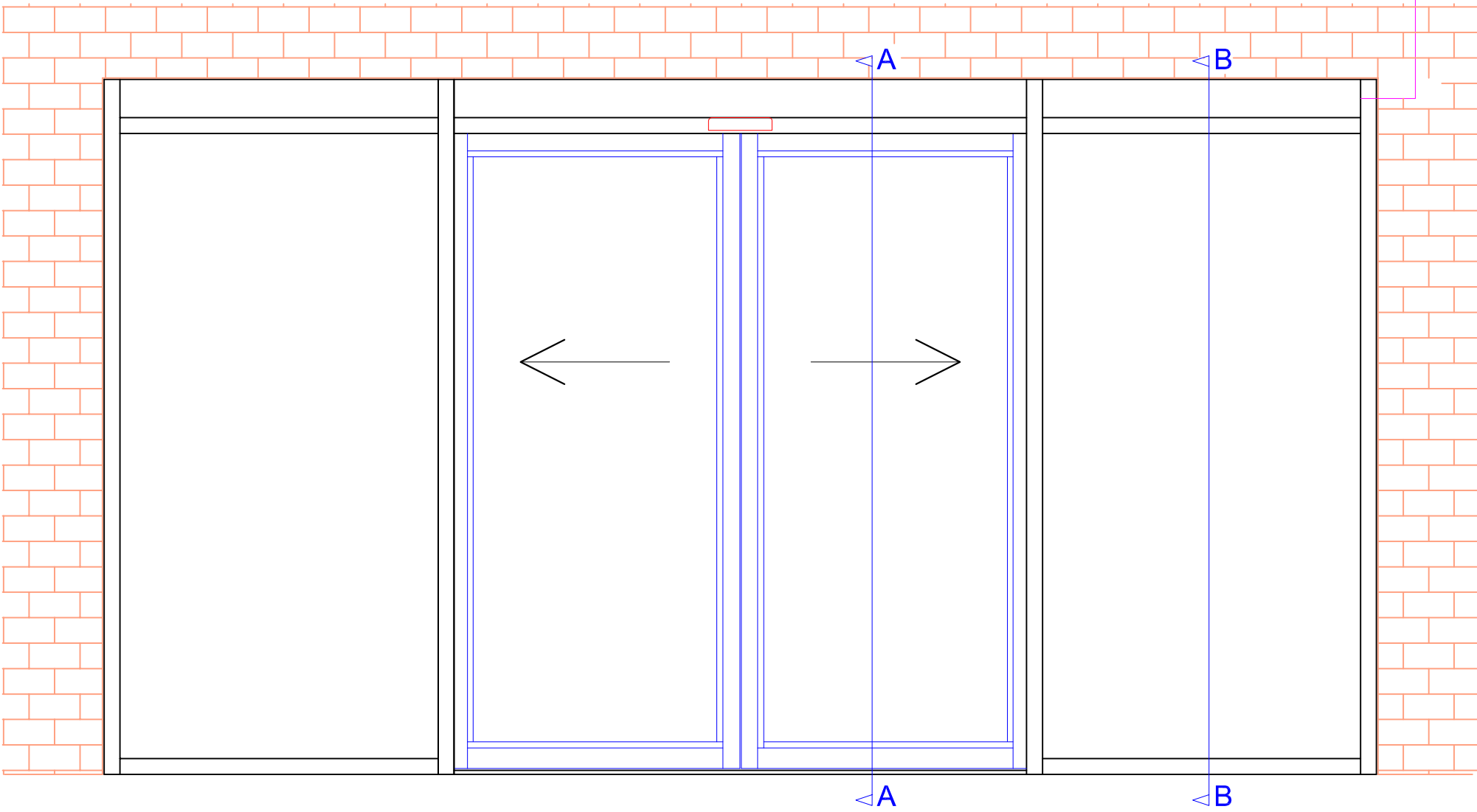
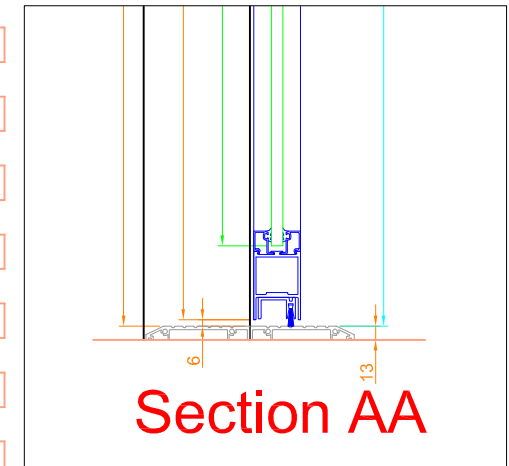
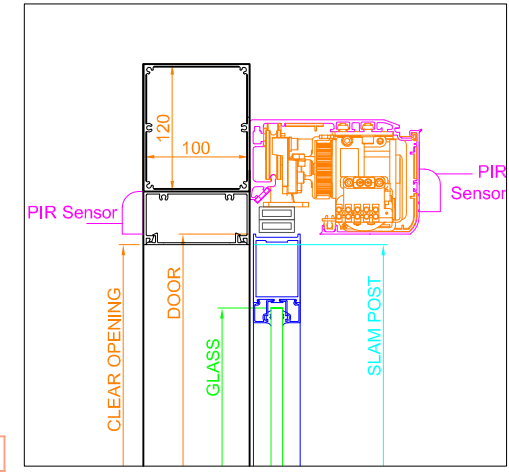

Specification

Framing : DSS range of non-thermally broken shop front sections
 Finish - PPC RAL TBC
 Door leaf fitted with 1No. Euro-profile manual hook lock.
 Frame Glass :10.8mm Clear Laminated Safety Glass
 Door Glass:- 6.4mm Clear Laminated Safety Glass
 Note : Manifestations to full height glazing to comply with current Building Regulations by others

Auto Specification

Automatic Doors : 1No. FDS A100 Bi-Parting Sliding Automatic Door complete with programme select positioned on the side of the operator.
 Activation: Radar operation internally and externally.
 The doors will open on activation from the fire alarm or mains power failure.
 Note : A normally open volt free fire alarm contact to within 1m of opening will be required and final connection to be by others.

Customer Obligation

To provide 1No., designated 240V switched, fused, illuminated spur to within 1m of opening for each door operator. Provide a normally open volt free fire alarm contact to within 1m of opening.
 All to be confirmed as installed prior to our arrival on site. Please note we will require unimpeded access to works location.
 All automatic door work to be carried out by an ADSA accredited engineer to BS7036:1996

Drawing For Approval



Job: _____
 Client: _____
 Dwg. Title: **Bi-Parting Sliding Door**

Drawn by: BW	Job No: -	Dwg. No:
Scale: NTS	Revision: -	-
Date: _____		

Required for drawing approval

Print : _____

Sign : _____

Date : _____

